

BOM(Restructured)				
NO	QTY	DESCRIPTION - W x L (GRAIN)	SIZE B	
1	2	ASSY, AUX .75 DIA LED WHITE, BULLET CONN (0358508)		
2	2	BRACKET, ENTRY STEP (TFM4901)		
3	2	BRACKET, ENTRY STEP (TFM4902)		
4	1	BRACKET, OH TIE TO ROOF (TFM4626)		
5	2	BRACKET, RUNNING BOARD (TFM4586)		
6	1	BRACKET, SIDEWALL MOUNT, LEFT SIDE (TFM6485)		
7	1	BRACKET, SIDEWALL MOUNT, RIGHT SIDE (TFM6484)		
8	1	CAP, FRONT (TGL0411)		
9	1	CAP, FRONT INNER (TPL1141)		
10	2	CLOSE OFF CAP (TCC9081)		
11	1	INSULATION 15X60, R7 UNF 562.5 RL (0111348)		
12	5	LIGHT, AUX, .75DIA, 1 LED, AMBER, .180 BULLET, GROMMET (0429348)		
13	12	NUT, M8 X 1.25 MM, FLANGE LOCKNUT G8 ZINC (0383153)		
14	1	PAD, STEP FRONT LH (TPL0919)		
15	1	PAD, STEP FRONT RH (TPL0918)		
16	1	RUNNING BOARD, LH (TGL0245)		
17	1	RUNNING BOARD, RH (TGL0244)		
18	1	TRIM, B-PILLAR LH (TPL0940)		
19	1	TRIM, B-PILLAR RH (TPL0939)		
20	1	TRIM, CABOVER BUNK (TPL0888)		
21	1	TRIM, CORNER FRONT LH (TPL0695)		
22	1	TRIM, CORNER FRONT RH (TPL0696)		
23	1	TRIM, TRANSITION (TPL1310)		
24	1	TRIM, TRANSITION (TPL1310)		
25	1	WINDOW, FRONT (TGL0318)		
26	1	WING, LH (TGL0412)		
27	1	WING, RH (TGL0413)		

FRONT CAP INSTALLATION GUIDELINES

1. LEVEL UNIT FRONT TO BACK AND SIDE TO SIDE.
2. INSTALL FRONT CAP JIG.
3. INSTALL ITEMS **6** & **7**, TO HOLD SIDEWALLS SQUARE TO FLOOR.
4. SET ITEMS **26** & **27** IN PLACE, LEAVE LOOSE FOR CAP INSTALLATION.
5. INSTALL FRONT CAP, OVERLAPPING ROOF BY APPROX. 2". SECURING CAP AT ROOF LINE, THEN ROTATING CAP DOWN UNTIL FLANGES OVERHANG SIDEWALL AND NEST INTO WINGS.
6. POSITION WINGS SO THEY MEET THE CONTOUR OF THE CAP.
7. SECURE WINGS TO CAB AND CAP TO WALL.
8. SEE SHEET 4 FOR SEAL DETAILS.
9. SEE TGL0387 ASSEMBLY, WINDOW FOR BONDING PROCEDURE.

REV	DESCRIPTION	DATE	BY	ECN
4	REVISED SIDEWALL MOUNT BRACKET, UPDATED FRONT CAP AND WINGS	9/11/2019	MG	17583
5	ADDED 1X3 LUMBER ON CAP NEAR FRONT WINDSHIELD	9/16/2019	HP	17652
6	SIKAFLEX252 REPLACING BUTYLE TAPE ON USE FOR SEAL INSIDE UNIT WHERE CAP, SIDEWALL & ROOF MEET	10/31/2019	HP	17875
7	ADDED NOTE TO PG4 FOR SIKA FLEX TO BE USED ON CROSS-SECTION OF SIDEWALLS	1/8/2020	MG	18055
8	LUMBER, 1 X 3 NEAR FRONT WINDSHIELD HAS BEEN REMOVED	3/23/2020	RN	18540

ALL DIMENSIONS ARE OUTSIDE FORM
 MATERIAL: Material <not specified>
 THICKNESS:
 WELD TYPE: GRADE A
 FINISH:
 LASER CUT RADII = .015 U.N.O.
 BEND RADII = MIN U.N.O.

TOLERANCE: SHEAR AND FORM: ± .030
 HOLE LOCATIONS: ± .015
 HOLE DIAMETERS: ± .005
 ANGULAR: ± 1°
 FLATNESS: ± .125/5 FT

THOR MOTOR COACH			
DRAWN BY AW	SHEET 1	OF 4	DATE 12/7/2018
DESCRIPTION ASSEMBLY, CAP FRONT			
MODEL MG/OM			
DRAWING NUMBER TFM6048			REVISION 8

© CONFIDENTIAL AND PROPRIETARY
 INFORMATION OF THOR MOTOR COACH. ANY
 REPRODUCTION IN PART OR AS A WHOLE
 WITHOUT OUR EXPRESS WRITTEN CONSENT
 IS PROHIBITED.

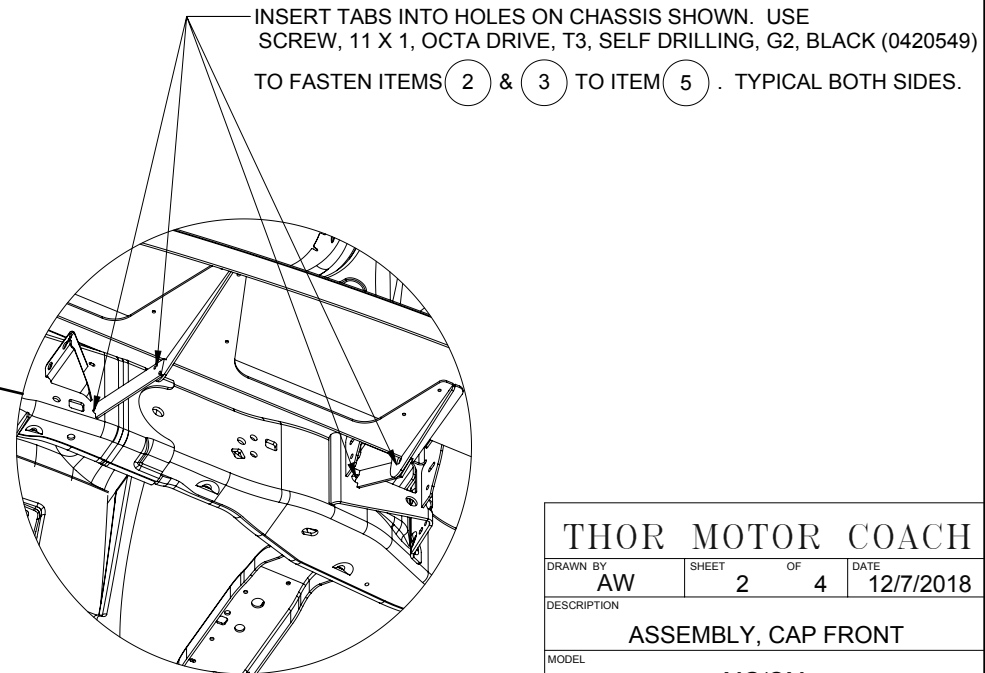
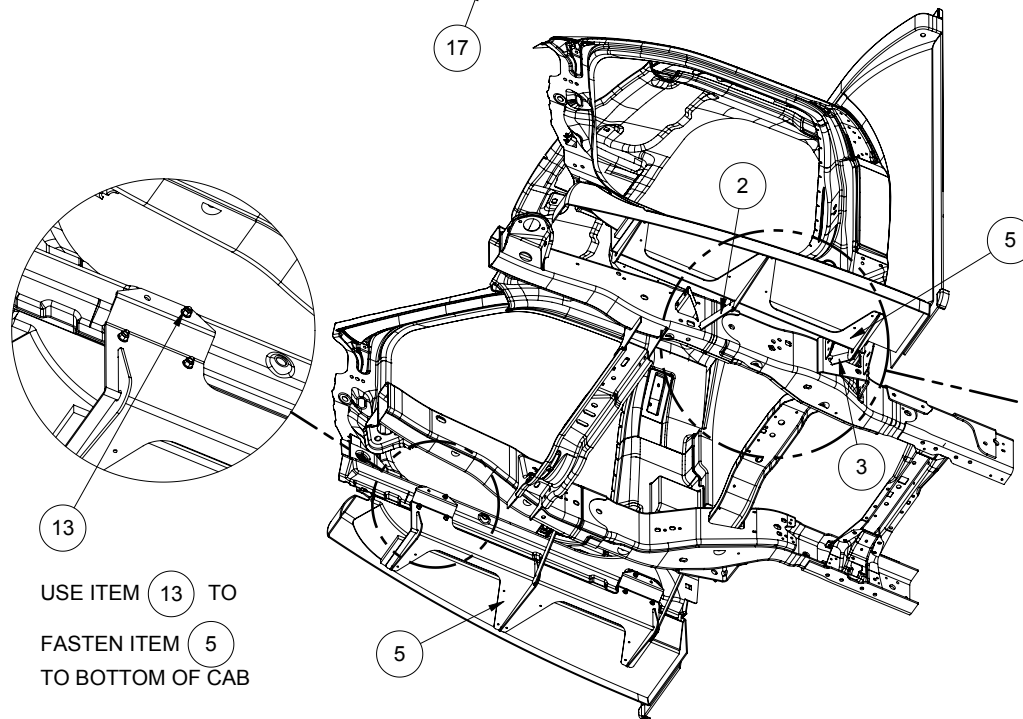
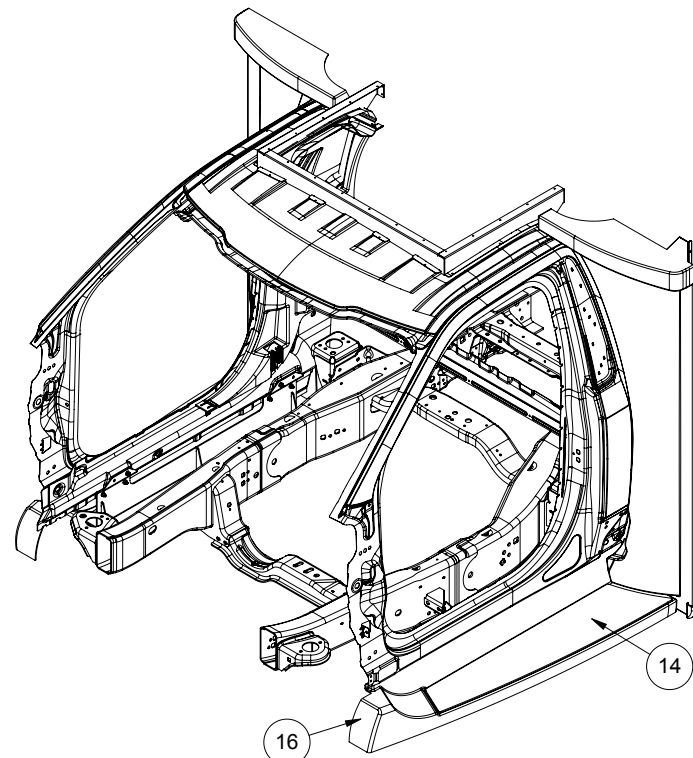
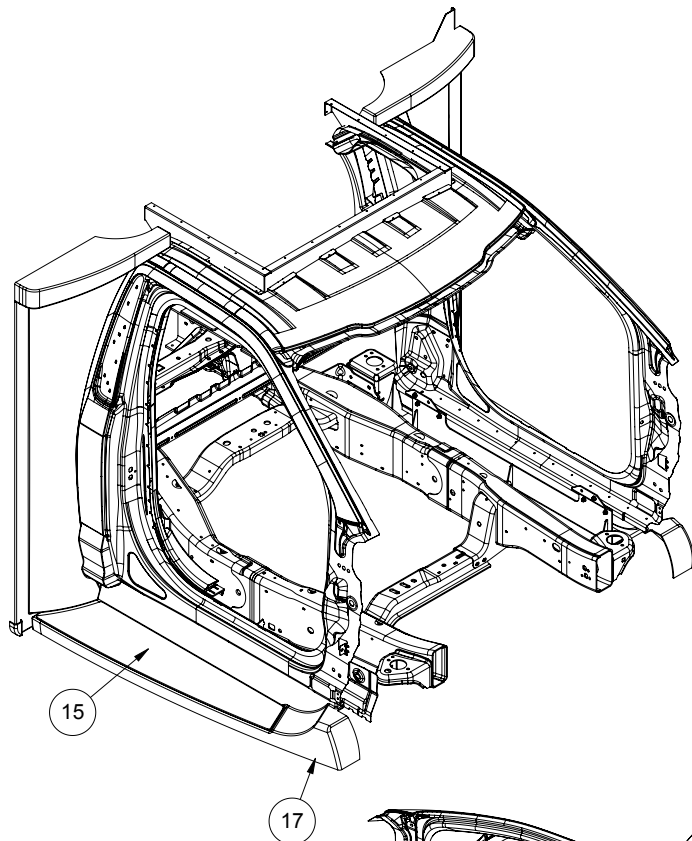

INSERT TABS INTO HOLES ON CHASSIS SHOWN. USE SCREW, 11 X 1, OCTA DRIVE, T3, SELF DRILLING, G2, BLACK (0420549) TO FASTEN ITEMS (2) & (3) TO ITEM (5) . TYPICAL BOTH SIDES.

USE ITEM (13) TO FASTEN ITEM (5) TO BOTTOM OF CAB

VIEWED FROM BOTTOM

THOR MOTOR COACH			
DRAWN BY AW	SHEET 2	OF 4	DATE 12/7/2018
DESCRIPTION ASSEMBLY, CAP FRONT			
MODEL MG/OM			
© CONFIDENTIAL AND PROPRIETARY INFORMATION OF THOR MOTOR COACH. ANY REPRODUCTION IN PART OR AS A WHOLE WITHOUT OUR EXPRESS WRITTEN CONSENT IS PROHIBITED.			REVISION 8
DRAWING NUMBER TFM6048			

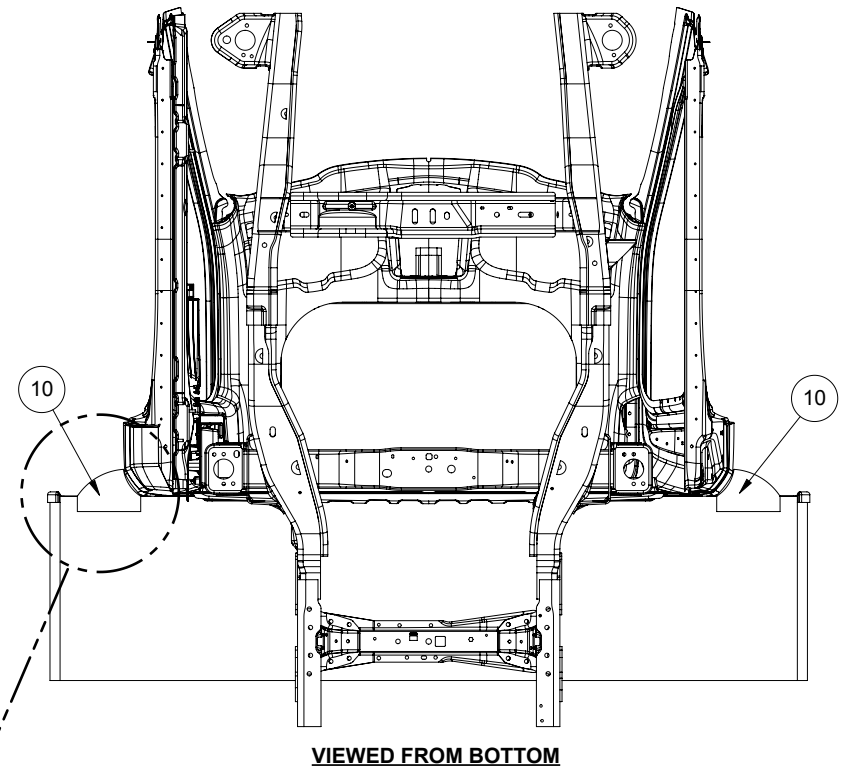
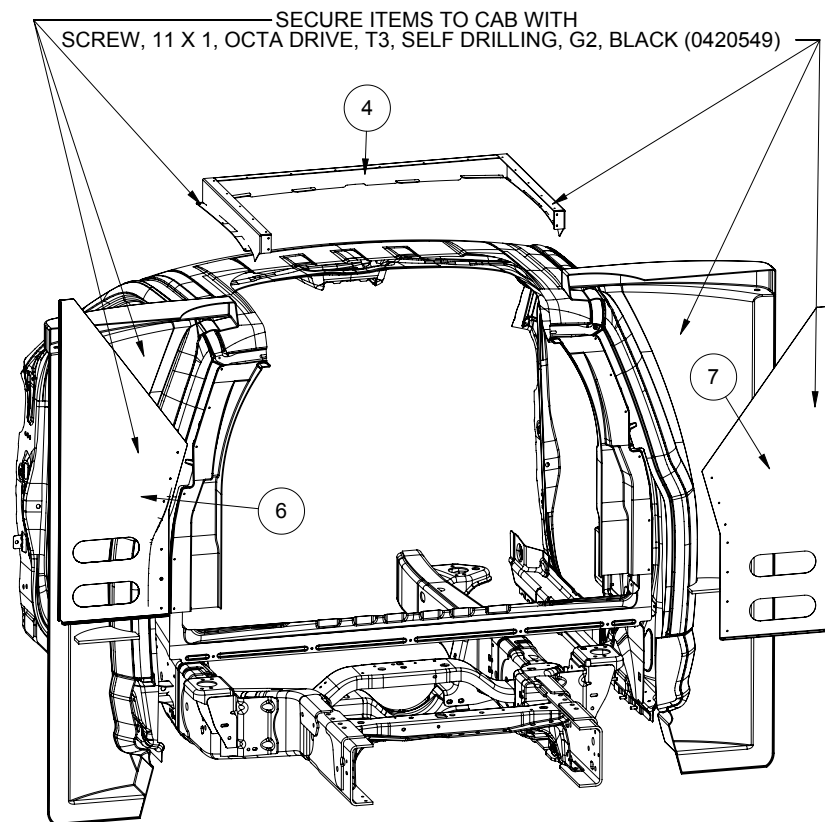

2.250
EDGE OF
FLOOR

2.000 BUTT INTO
FRONT TRUSS

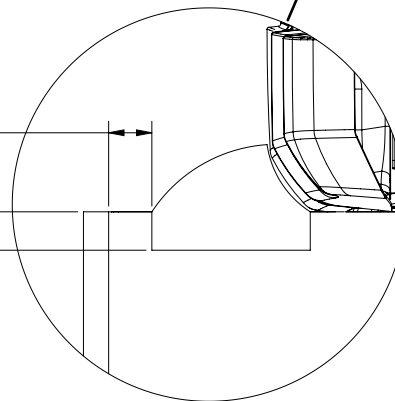

THOR MOTOR COACH

DRAWN BY AW	SHEET 3	OF 4	DATE 12/7/2018
-----------------------	-------------------	----------------	--------------------------

DESCRIPTION ASSEMBLY, CAP FRONT

MODEL MG/OM

<small>© CONFIDENTIAL AND PROPRIETARY INFORMATION OF THOR MOTOR COACH. ANY REPRODUCTION IN PART OR AS A WHOLE WITHOUT OUR EXPRESS WRITTEN CONSENT IS PROHIBITED.</small>	DRAWING NUMBER TFM6048	REVISION 8
--	----------------------------------	----------------------

FRONT

APPLY ADHEZION
ADHESIVE AROUND WINDOW
BETWEEN CAP AND PLASTIC
(TYP.)

APPLY ADHEZION
ADHESIVE
BETWEEN CAP AND PLASTIC
(TYP.)

△ 6 APPLY SIKAFLEX 252
INSIDE OF UNIT
WHERE
CAP, SIDEWALL AND
ROOF (TYP.) MEET

APPLY SIKAFLEX 252
BETWEEN CAB, WINGS AND CAP
(TYP.)

△ 7 APPLY SIKAFLEX 252
TO CROSS-SECTION
OF SIDEWALL PRIOR
TO WING INSTALLTION
(TYP BOTH SIDES)

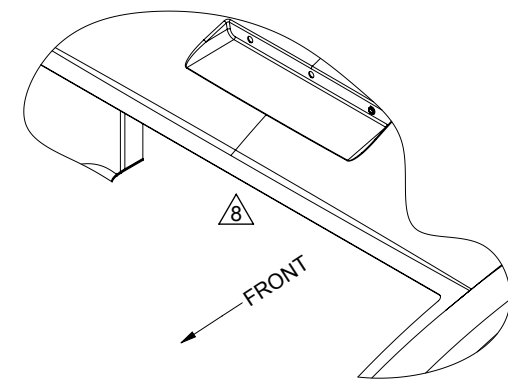

APPLY SPRAY FOAM
BETWEEN
CAP AND WING
(TYP.)

SEE
DETAIL A

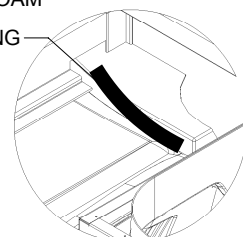

DETAIL A
VIEWED FROM INSIDE

APPLY SIKAFLEX 252 BETWEEN
BRACKET, OH TIE ROOF AND CAB ROOF
(TYP.)

APPLY SPRAY FOAM
BETWEEN CLOSSE OFF
,CAP AND WING (TYP.)

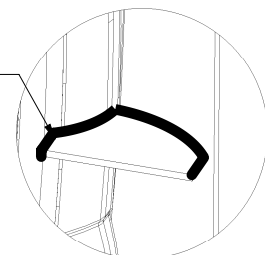

DETAIL H

SEAL DETAIL

THOR MOTOR COACH

DRAWN BY AW	SHEET 4	OF 4	DATE 12/7/2018
DESCRIPTION ASSEMBLY, CAP FRONT			
MODEL MG/OM			
© CONFIDENTIAL AND PROPRIETARY INFORMATION OF THOR MOTOR COACH. ANY REPRODUCTION IN PART OR AS A WHOLE WITHOUT OUR EXPRESS WRITTEN CONSENT IS PROHIBITED.			DRAWING NUMBER TFM6048
			REVISION 8